

TUFWAY®

Portable Restroom Assembly Instructions

WITH TUFWAY EASTERN

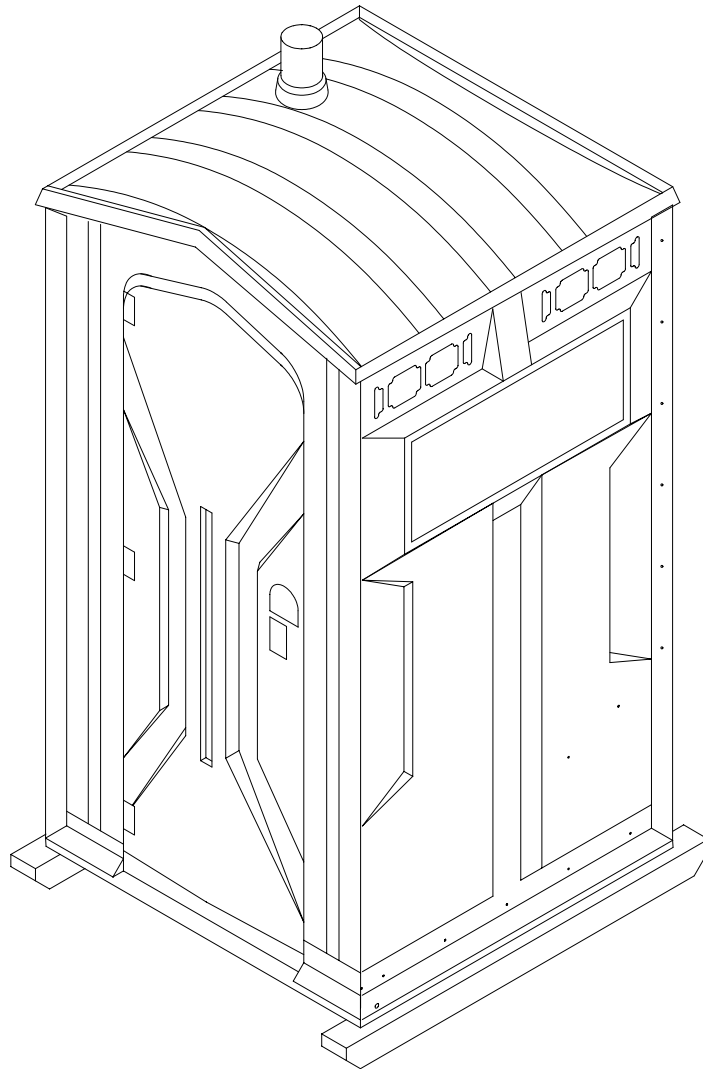

2530 Xenium Lane North, Minneapolis, MN 55441
Telephone: 763-553-1900 / Fax: 763-553-1905
800-328-3332/ www.satelliteindustries.com

INTRODUCTION

These Assembly Instructions cover the Tufway portable restroom. Satellite portable restrooms must be assembled according to approved assembly procedures. Avoid variations in assembly which could adversely affect product life.

IMPORTANT: Do not remove shipping screw from door until instructed to in the "Install the Front Assembly" step.

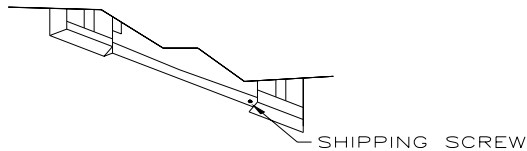

- The assembly procedures are written for assembly of single units. If assembling multiple units, considerable efficiency can be gained by having a crew working in assembly line fashion.

TOOLS

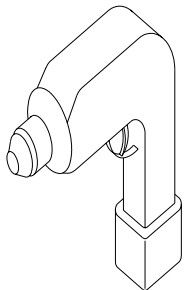

- DRILL ELEC/CORDLESS
- APRON (CARPENTERS)
- 1/4" DRILL BIT (DRILL URINAL AND TP HOLDER)
- 13/32 DRILL BIT (DRILL FRONT WITH ROTOMOLDED BASE)
- BLOCK OF WOOD (SUGGEST A 2"X2"X10" LONG)
- NUT DRIVER 3/8"

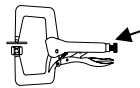

- RIVET CRIMPING TOOL (SATELLITE PN11593)
- RIVET GUN (SATELLITE TOOL PLASTIC RIVET INSTALLER #15814)
- PHILLIPS SCREWDRIVER
- 1/2" RACHETING BOX END WRENCH
- 5/16" DRILL BIT
- HAMMER

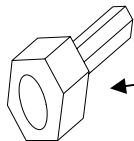
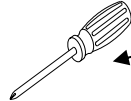

HELPFUL HINTS

- Keep panels out of direct sunlight
- Have an apron with at least two large pockets, easy to get parts out of
- Don't open up all your kit boxes. Open up only enough fit boxes to assemble the number of toilets you are currently working on. **KEEP PARTS ORGANIZED.**
- Use toilet paper holders for parts bins on multiple unit assembly
- The door latch can be put on at any time. It may be more efficient to have someone do this early on multiple unit assembly.

PARTS LIST (HDWE #15567)

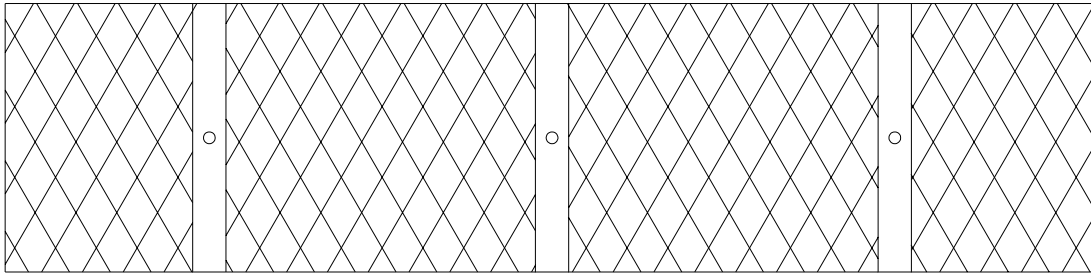

15

PN 14112
SCREEN 3.8 X 15.25 PLSTC VENT (NTS)

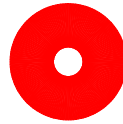

24

PN 16844

SPINDLE, PAPERGUARD II (NTS)

13

PN 10068
WASHER, 3/16" RUBBER

21

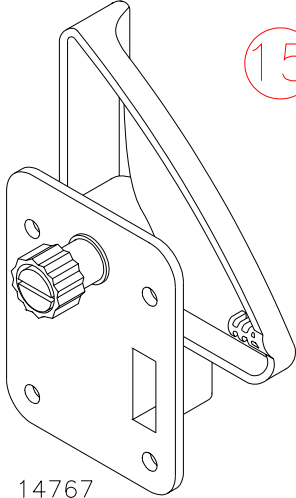

PN 14767
LATCH, RESTROOM PLASTIC (NTS)

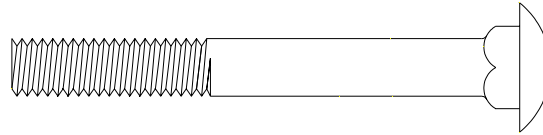
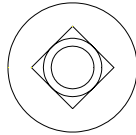

16

PN 13173
BOLT, 5/16" X 2-3/4" CARRIAGE

12b

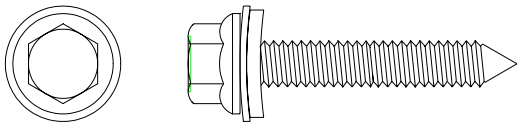

PN 14768
BOLT, 1/4" X 1-1/2" PINCH GOLD

18



PN 10769
NUT, 5/16" NC

12a

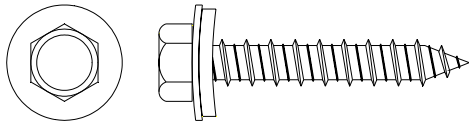

PN 13860
SCREW, #14 X 1-1/2" W/WSH GOLD

17

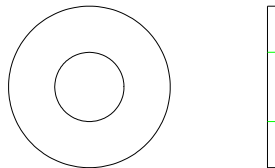

PN 11368
WASHER, 5/16" FLAT STNLS

11

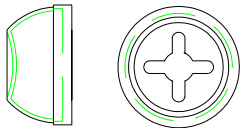

PN 10047
PUSH CAP, 3/16" ID

22

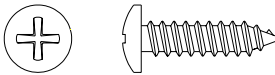

PN 10122
SCREW, #10 X 3/4" PN PH TAP

10

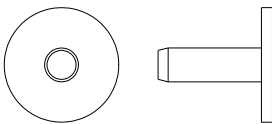

PN 10629
RIVET, SOLID SHORT

23

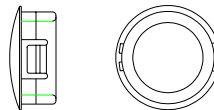

PN 10161
PLUG, 1/2" ROUND BLACK PLASTIC

14

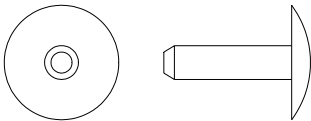

PN 10801
RIVET, SOLID LONG

19

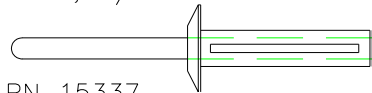

PN 15337
RIVET, .195" PLASTIC EXPANDING

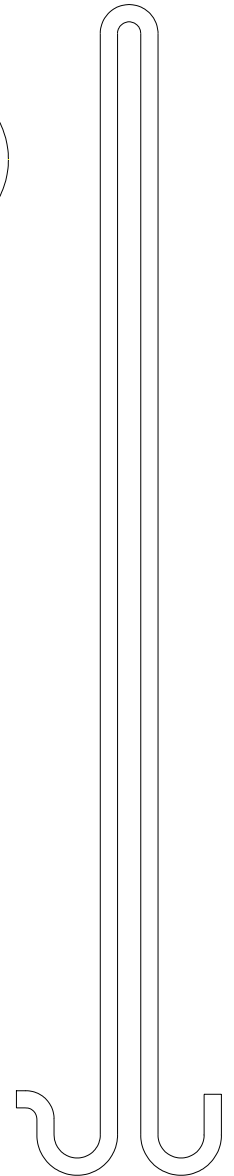

DRAWN TO SCALE

UNIT ASSEMBLY DRAWING

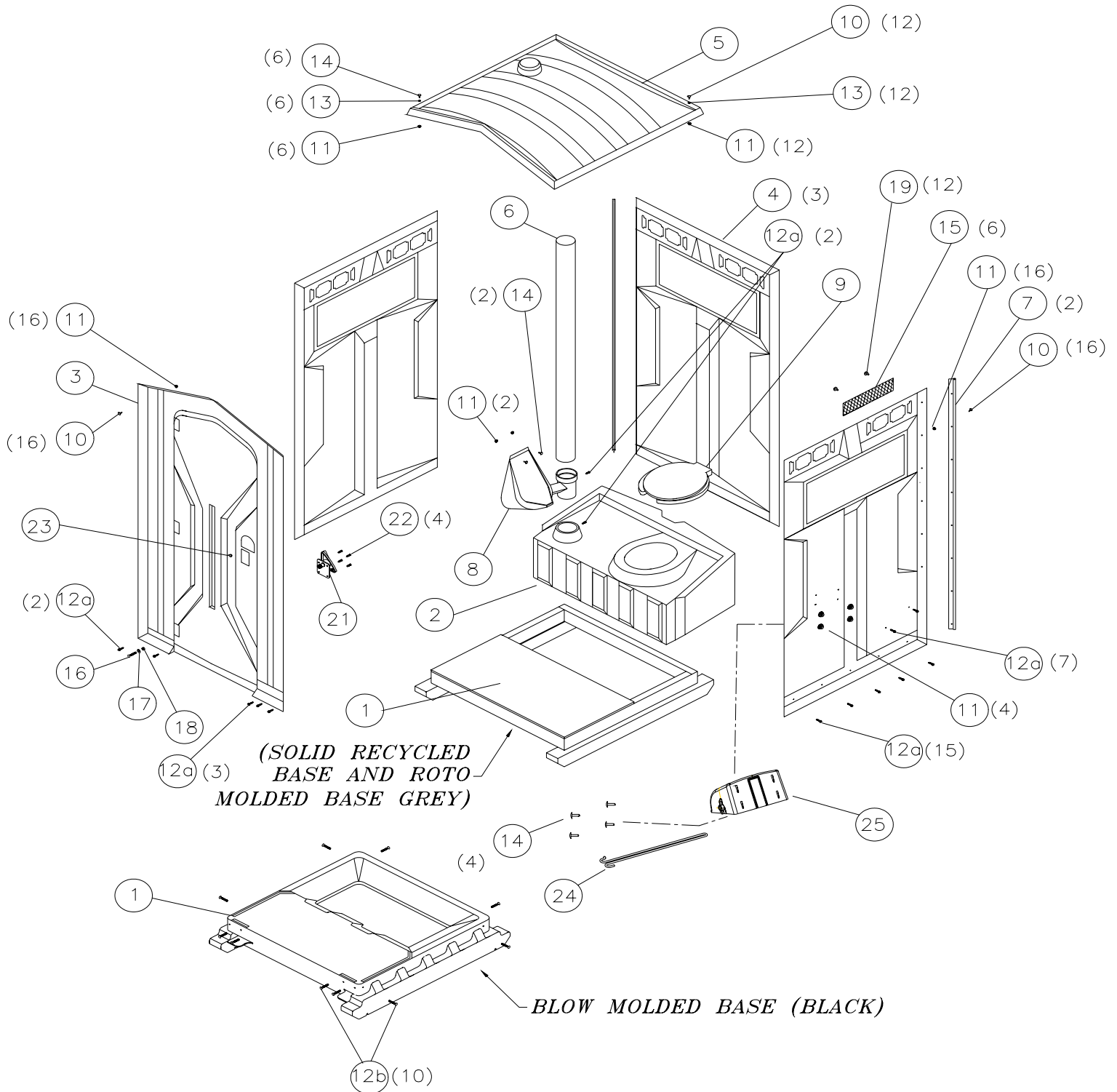

PARTS LIST

25	17082	1	HOOD, PAPERGUARD II GREY
24	16844	1	SPINDLE, PAPERGUARD II
23	10161	1	PLUG, 1/2" ROUND BLACK PLASTIC
22	10122	4	SCREW, #10 X 3/4" PN PH TAP
21	14767	1	LATCH, RESTROOM PLASTIC
20	10900	1	INSTRUCTIONS, TUFWAY (NOT SHOWN)
19	15337	12	RIVET, .195" PLASTIC EXPANDING
18	10769	1	NUT, 5/16 NC
17	11368	1	WASHER, 5/16" FLAT STLS
16	13173	1	BOLT, 5/16" X 2-3/4" CARRIAGE
15	14112	6	SCREEN, 3.8 X 15.25 PLSTC VENT
14	10801	12	RIVET, SOLID LONG
13	10068	21	WASHER, 3/16" RUBBER
12b	14768	10	BOLT, 1/4" X 1-1/2" PINCH GOLD
12a	13860	29	SCREW, #14 X 1-1/2" W/WSH GOLD
11	10047	56	PUSH CAP, 3/16" ID
10	10629	44	RIVET, SOLID SHORT
9	10570	1	SEAT, TOILET
8	15334	1	DESIGN, STANDOVER URINAL
7	16048	2	DESIGN, CORNER MOLDING II
6	14133	1	VENT PIPE, 4" X 62" BLACK
5	16044	1	DESIGN, DOME TUFWAY ROOF (STD VENT OPTION)
4	15450	3	DESIGN, TUFWAY PANEL
3	15562	1	DESIGN, TUFWAY FRONT ASSY (STD OPTION)
2	15955	1	DESIGN, TUFWAY TANK
1	16112	1	BASE, BLM RCYL BLACK
	19014	1	BASE, TUFWAY ROTOMOLDED
	15852	1	BASE, 4X4 RECYCLED PLASTIC
ITEM #	PART #	QTY	DESCRIPTION

DIRECTIONS

1. JOIN PANELS TOGETHER WITH CORNER MOLDING

SET REAR PANEL ON A BOX AT LEAST 40" HIGH BUT NOT WIDER THAN 41". IF ASSEMBLING SINGLE UNITS, THE WASTE TANK WILL DO.

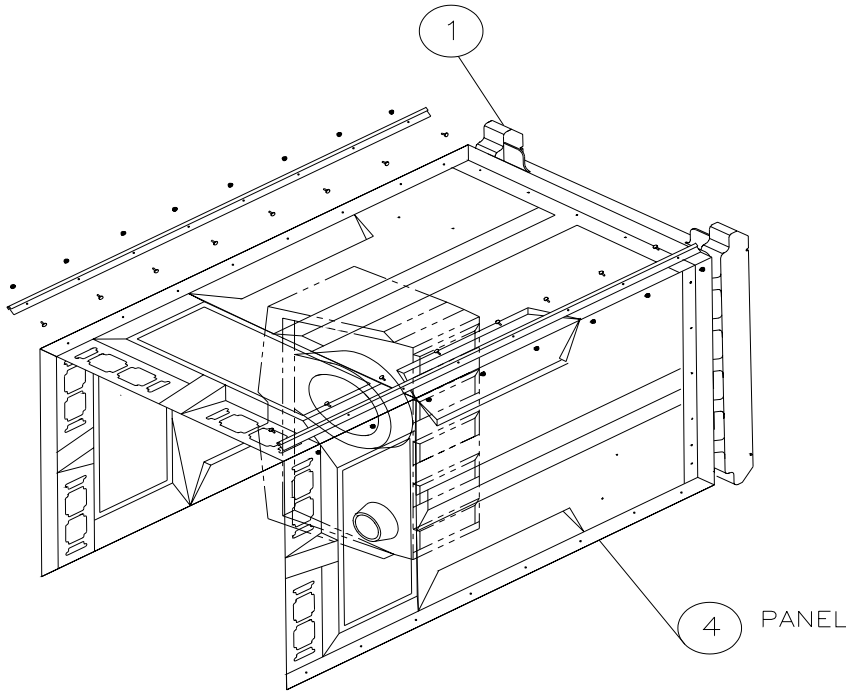

DISTANCE FROM RIVET HOLE TO END OF MOLDING IS NOTICEABLY SHORTER AT TOP OF CORNER MOLDING

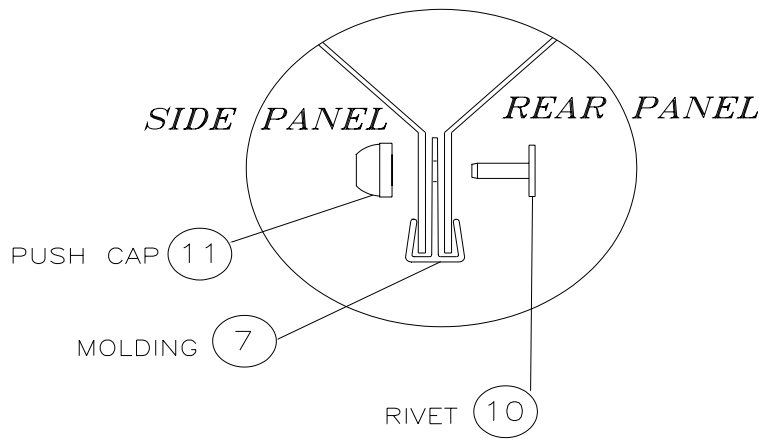
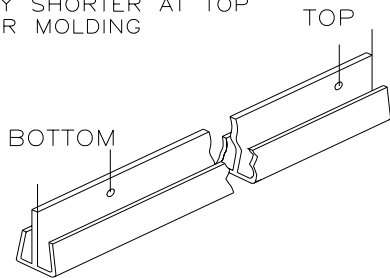

USING THE C-CLAMP TOOL, MAKE SURE ALL RIVETS AND PUSH CAPS ON BOTH PANELS ARE CLAMPED TIGHT.

2. ATTACH BASE TO PANELS

TIP BASE UP AND POSITION INSIDE PANELS. USING THE DRILL AND 3/8" NUT DRIVER BIT.

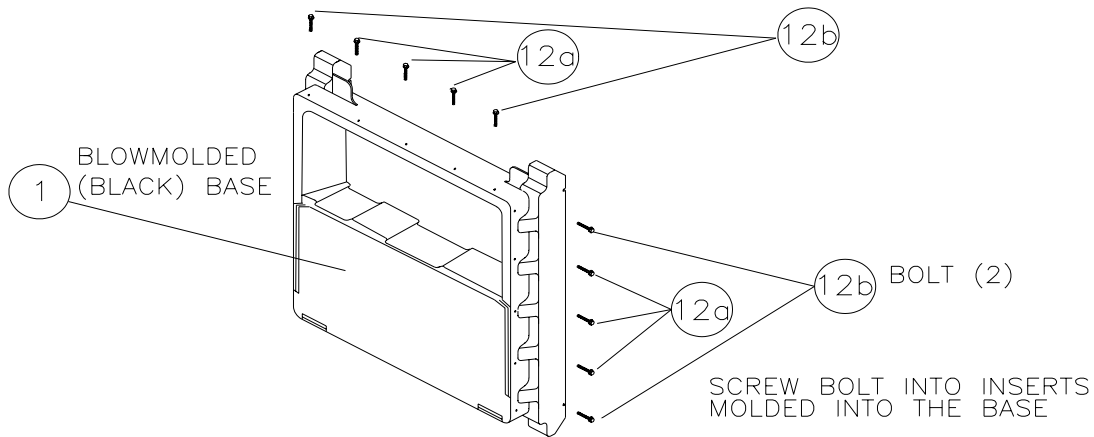

NOTE: BE CAREFUL WHEN SCREWING THE BOLT INTO THE INSERT NOT TO CROSS THREAD BOLTS. AFTER BOLTS (14768) HAVE BEEN SCREWED INTO THE INSERTS, FINISH ATTACHING THE PANELS TO THE PLASTIC BASE USING LAG SCREWS (PN 13860). TIGHTEN SCREWS UNTIL RUBBER WASHER STARTS TO FLATTEN - BE CAREFUL NOT TO OVER TIGHTEN.

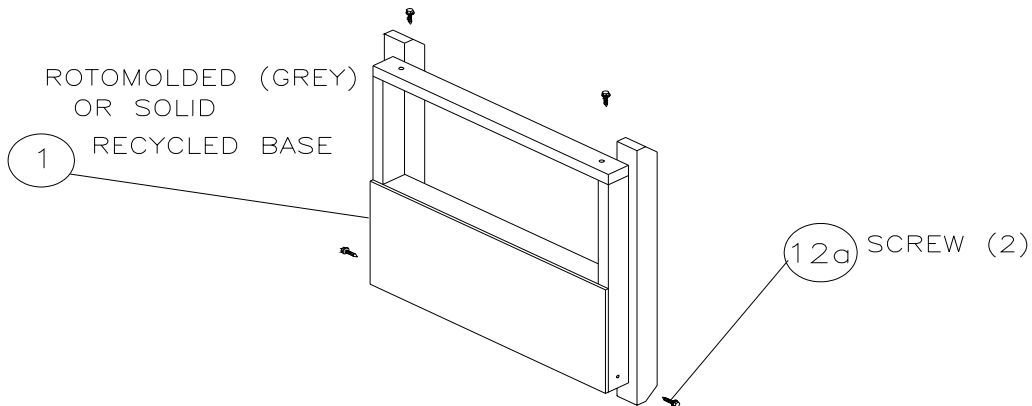

FIRST FASTEN PANELS TO BASE WITH LAG SCREWS (PN 13860) INTO DIMPLES CIRCLED ON BASE AT LOCATION SHOWN, THEN FINISH ATTACHING THE PANELS TO THE BASE USING 11 LAG SCREWS (PN 13860).

3. ATTACH ROOF TO PANELS

TIP ROOF UP AND POSITION OVER PANELS

USING THE C-CLAMP TOOL, MAKE SURE ALL CAPS AND RIVETS ARE CLAMPED TIGHT UNTIL RUBBER WASHERS ARE COMPRESSED.

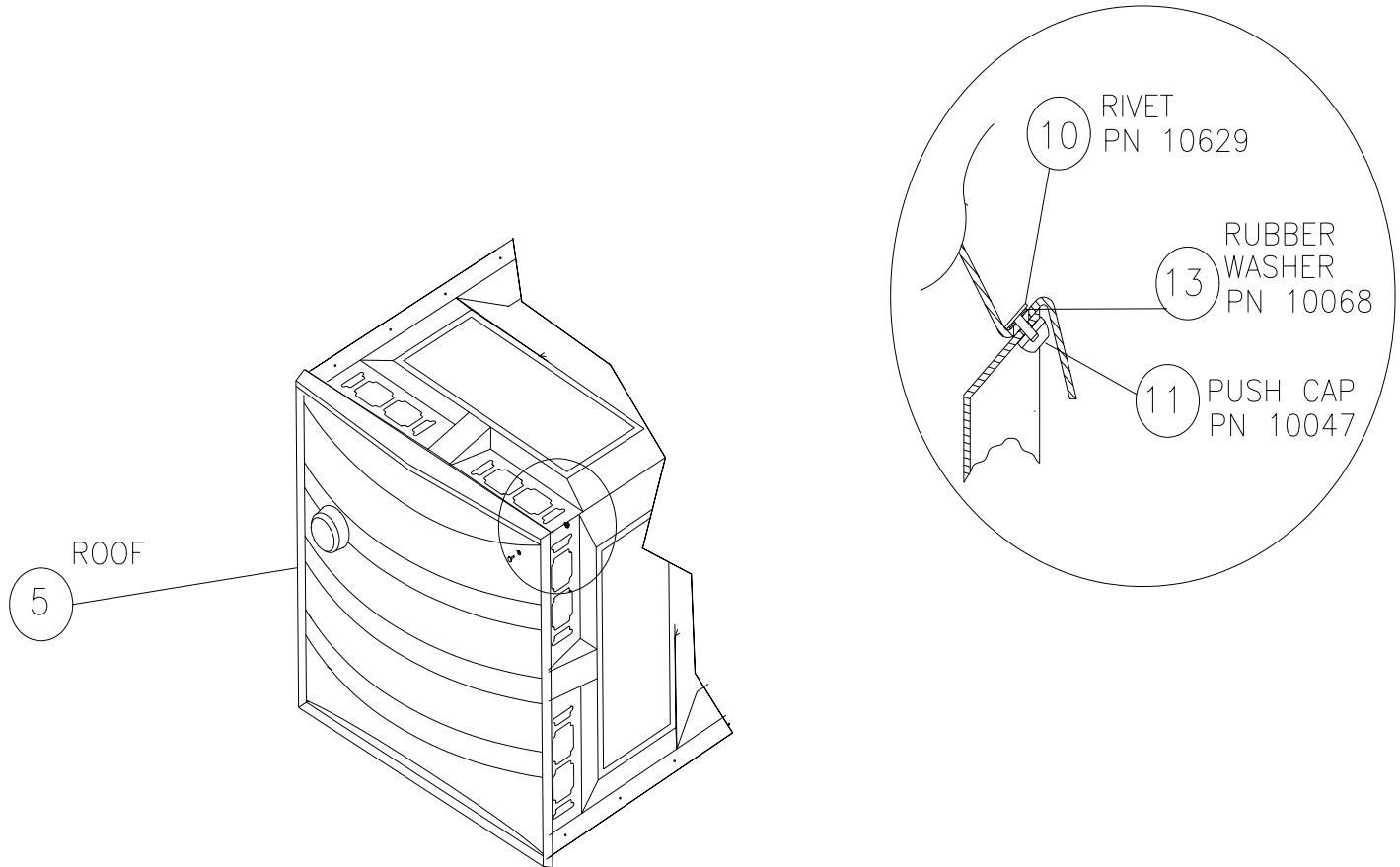

STAND UNIT UP ON BASE FOR THE NEXT ASSEMBLY STEPS

4. PLACE TANK IN UNIT

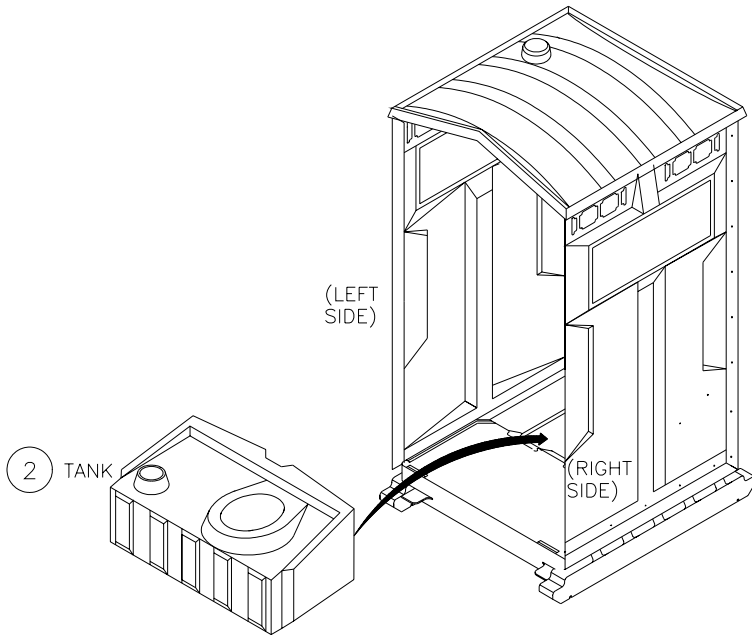

5. ATTACH TANK TO PANELS FROM OUTSIDE

IT IS IMPORTANT THAT THE TANK IS SEATED PROPERLY WHILE ATTACHING THE SIDE PANELS. HAVE ONE PERSON STAND IN TANK WHILE LAGGING PANELS TO TANK. USING THE DRIVER AND 3/8" NUT DRIVER BIT. TIGHTEN SCREWS UNTIL RUBBER WASHER BEGINS TO FLATTEN – BE CAREFUL NOT TO OVER TIGHTEN SCREWS.

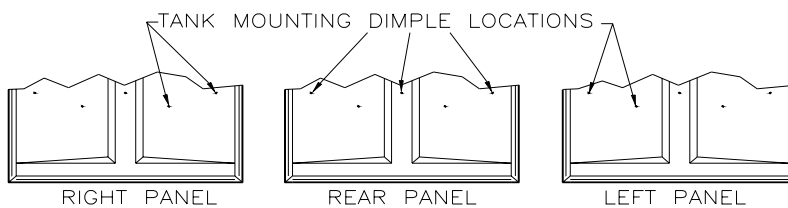
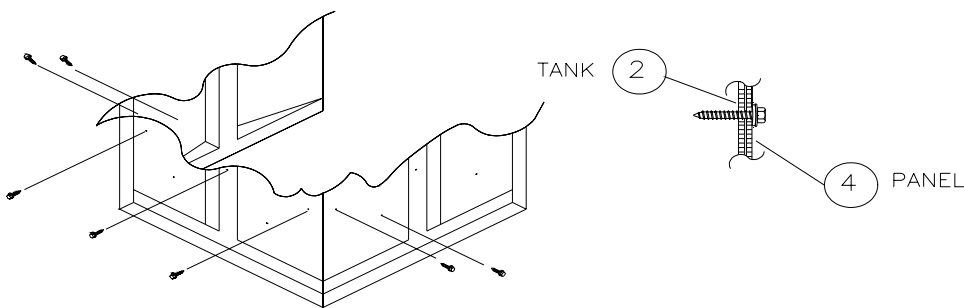

IF INSTALLING AN EASTERN TANK, THE TANK SHOULD BE LAGGED 15" ABOVE THE BOTTOM OF THE PANEL, DIRECTLY BELOW THE DIMPLES SHOWN.

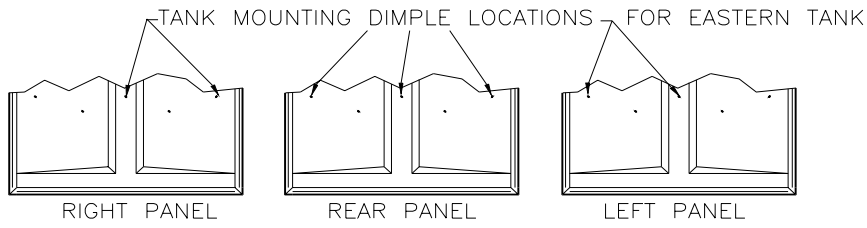

6. INSTALL URINAL

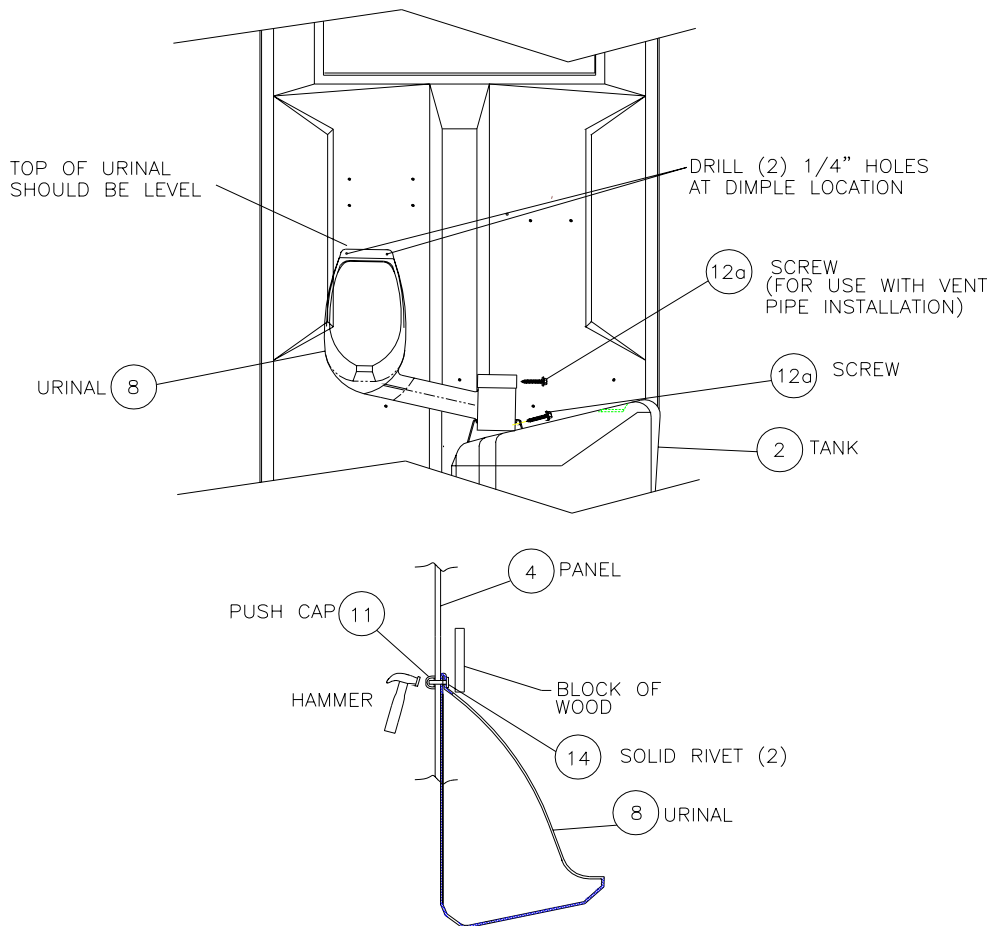

7. INSTALL VENT SCREEN

USING A POP RIVET TYPE GUN OR (SATELLITE RIVET GUN TOOL #15814)

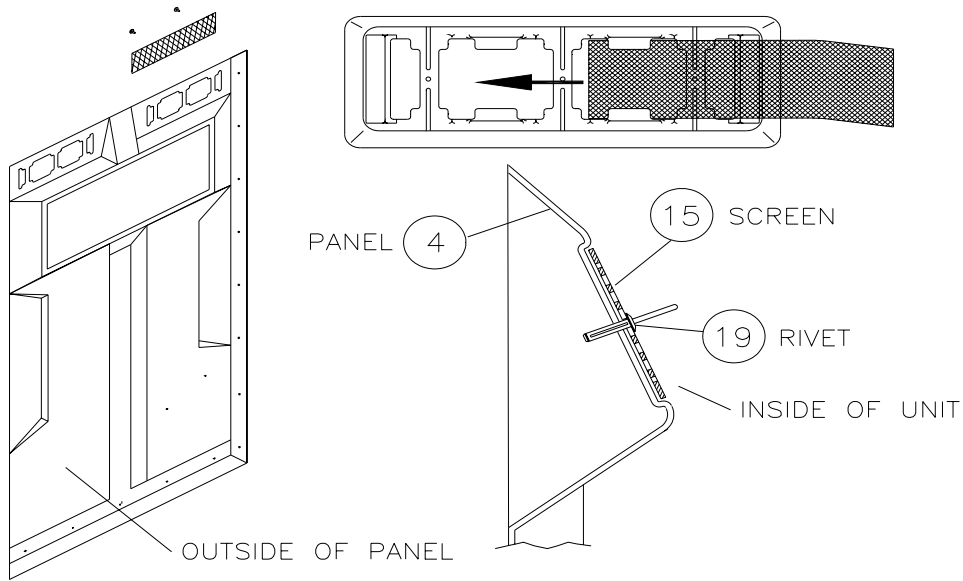

8. INSTALL VENT PIPE

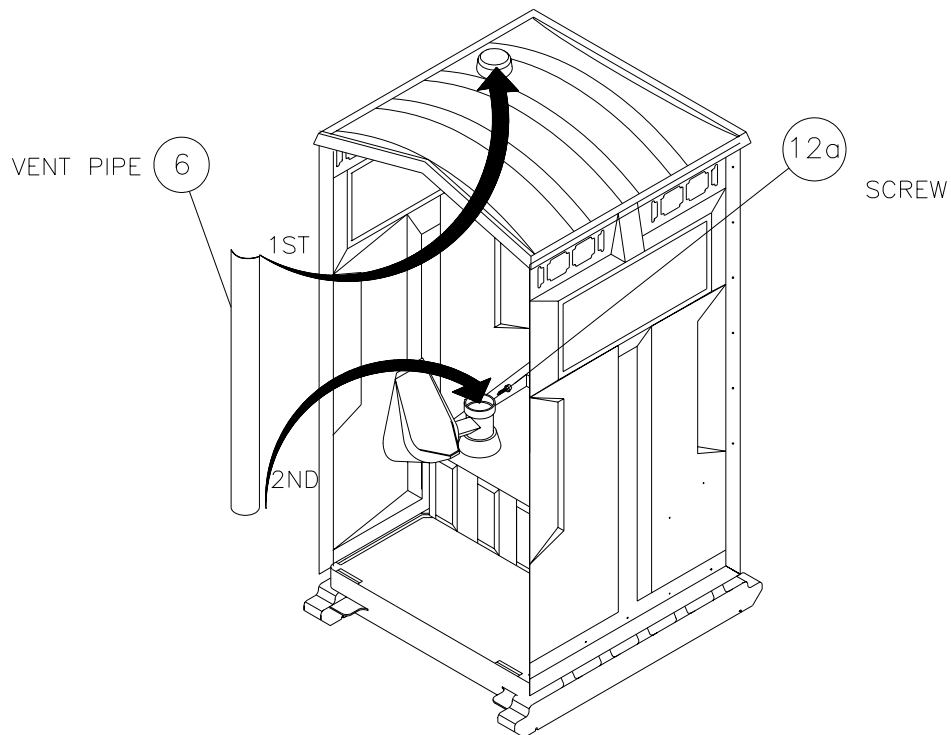

9. INSTALL PAPERGUARD

NOTE: IF INSTALLING OTHER OPTIONAL ACCESSORIES SUCH AS A SLIMMATE SINK, THE PAPERGUARD MAY HAVE TO BE MOVED TO A DIFFERENT LOCATION.

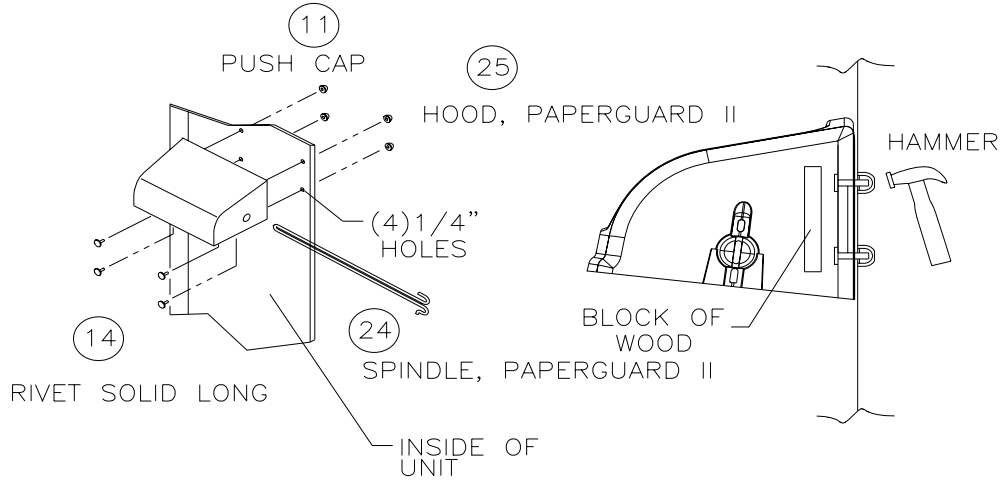

DRILL FOUR 1/4" HOLES AT DIMPLES ON RIGHT SIDE PANEL, INSTALL PAPERGUARD USING (4) RIVETS AND (4) PUSH CAPS

10. ATTACH TOILET SEAT

USING A PHILLIPS OR FLAT HEAD SCREWDRIVER.

(TIGHTEN SEAT HINGE NUT SECURELY)

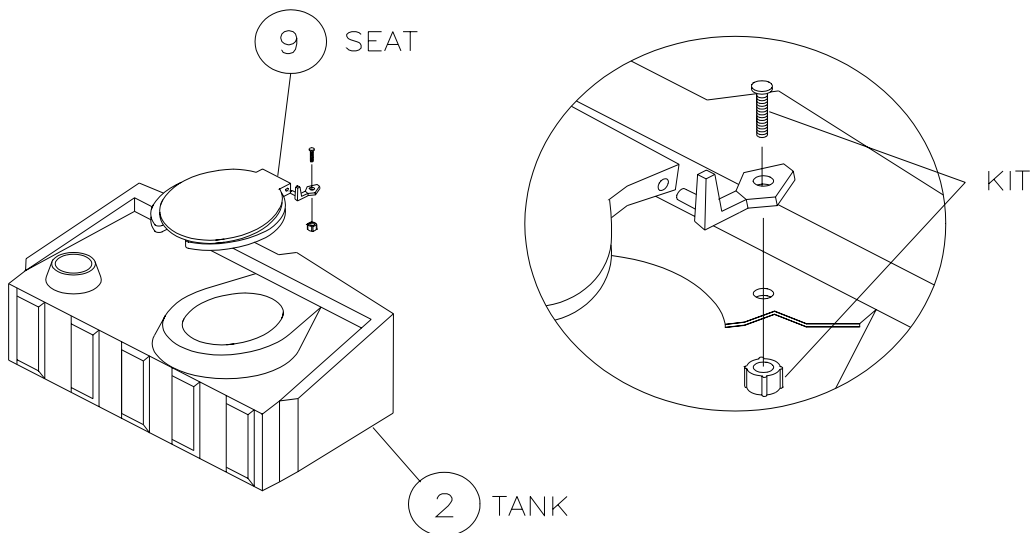

11. ATTACH ROOF TO FRONT ASSEMBLY

FOR THE FRONT INSTALLATION STEPS, LAY THE UNIT ON ITS REAR PANEL. USING THE C-CLAMP TOOL, MAKE SURE CAPS AND RIVETS ARE CLAMPED TIGHT UNTIL RUBBER WASHERS ARE COMPRESSED.

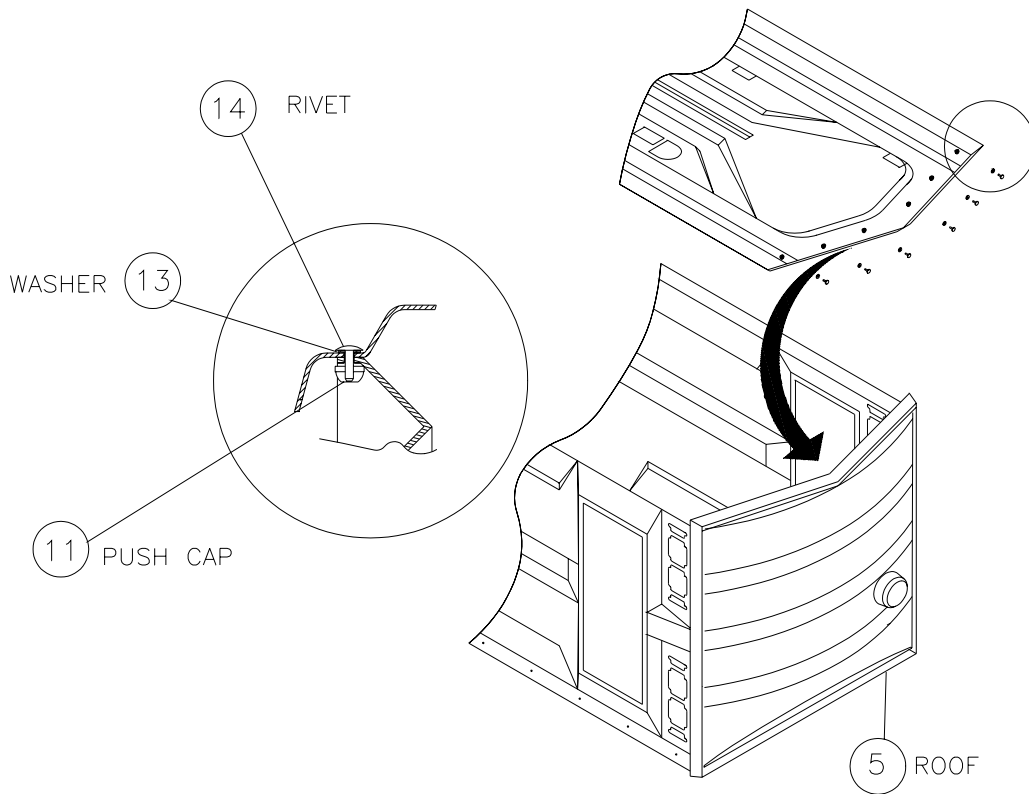

12. ATTACH RIGHT AND LEFT SIDE PANELS TO FRONT ASSEMBLY

USING THE C-CLAMP TOOL, MAKE SURE CAPS AND RIVETS ARE CLAMPED TIGHT.

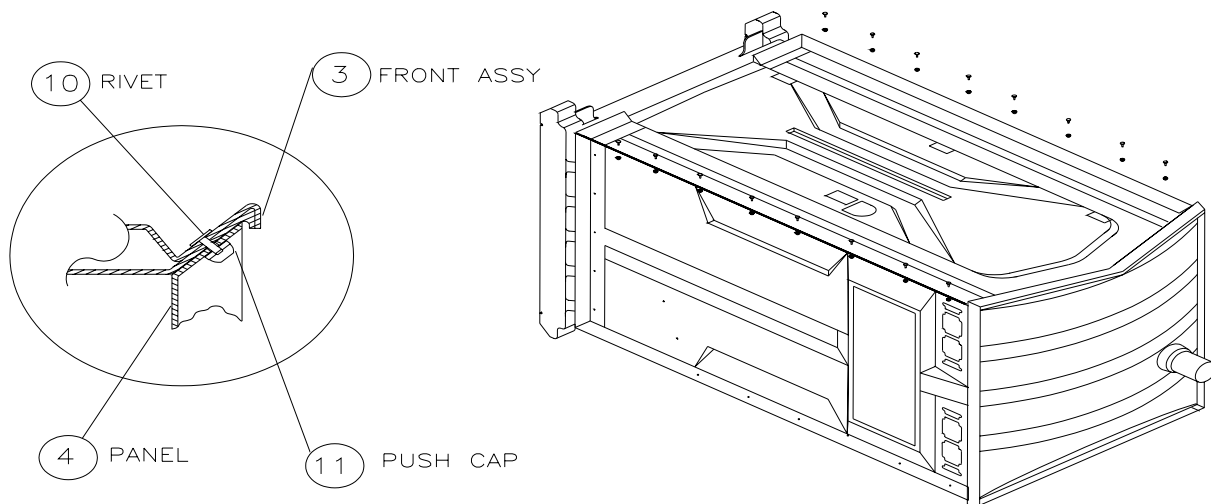

13. BOLT THE FRONT ASSEMBLY TO BASE

A. BLOW MOLDED BASE (BLACK)
 USING DRILL AND 3/8" NUT DRIVER

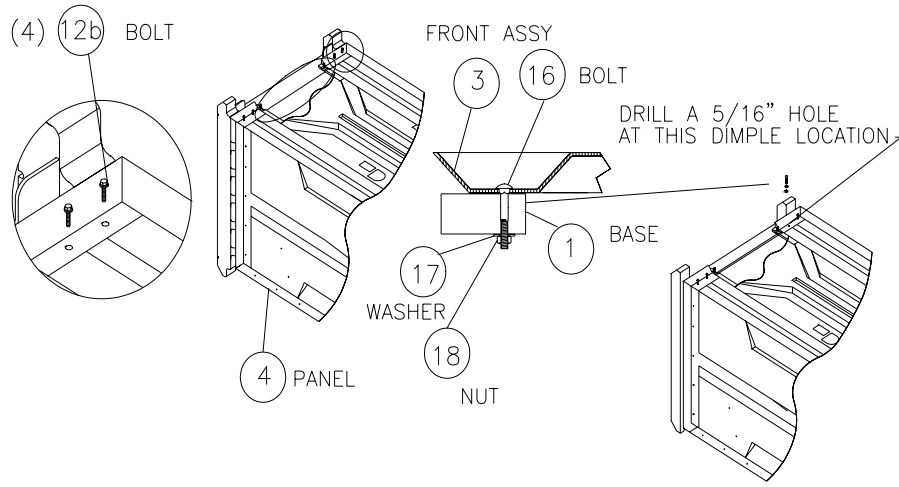

B. RECYCLED BASE
 USING 5/16" DRILL BIT, 3/8" NUT DRIVER,
 DRILL, AND 1/2" SOCKET

C. ROTOMOLDED BASE (GREY)
 USING 13/32" DRILL BIT, 3/8" NUT DRIVER,
 DRILL, AND 1/2" SOCKET
 ON THE LEFT DOOR FRAME ENLARGE THE
 LEFT HOLE WITH A 13/32" DRILL BIT. INSTALL
 THE CARRIAGE BOLT ON 2ND HOLE FROM LEFT.
 ON THE RIGHT, ENLARGE (2) HOLES THRU FRONT
 WITH 13/32" DRILL BIT INSTALL LAG SCREWS INTO
 CORED HOLES IN BASE.
 REMOVE SHIPPING SCREW, INSTALL (2) LAG SCREWS
 AT DIMPLE IN DOOR JAMB.

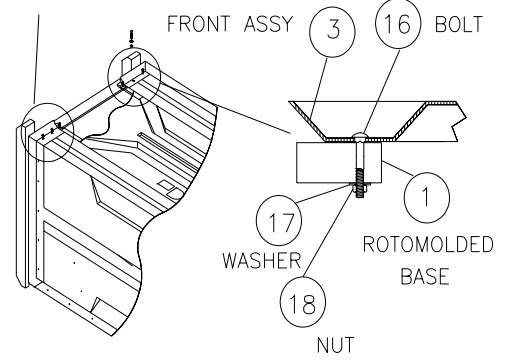

14. SCREW THE FRONT ASSEMBLY TO SKID ASSEMBLY

(TIGHTEN LAG SCREW UNTIL RUBBER WASHER BEGINS TO FLATTEN – DO NOT OVER TIGHTEN.)

A. BLOW MOLDED BASE (BLACK)
 USING DRILL AND 3/8" NUT DRIVER

B. RECYCLED BASE OR ROTOMOLDED BASE (GREY)

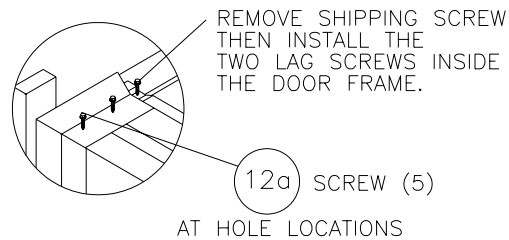
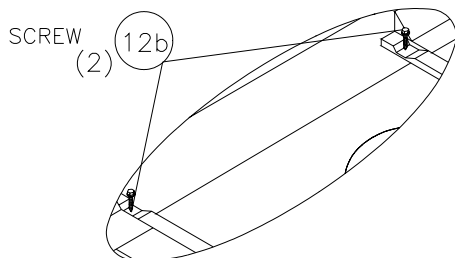

15. INSTALL DOOR LATCH USING A PHILLIPS SCREWDRIVER

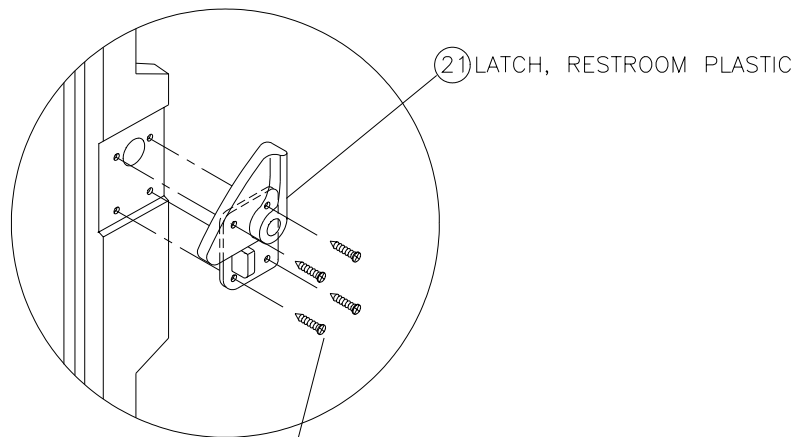

(22)
SCREW, #10 X 3/4"
PN PH TAP (4)

BE CARREFUL NOT TO
OVERTIGHTEN SCREWS

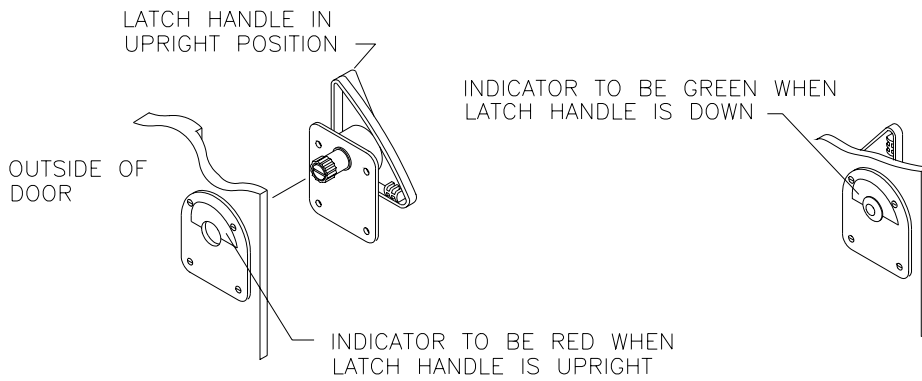

EASTERN TANK OPTION

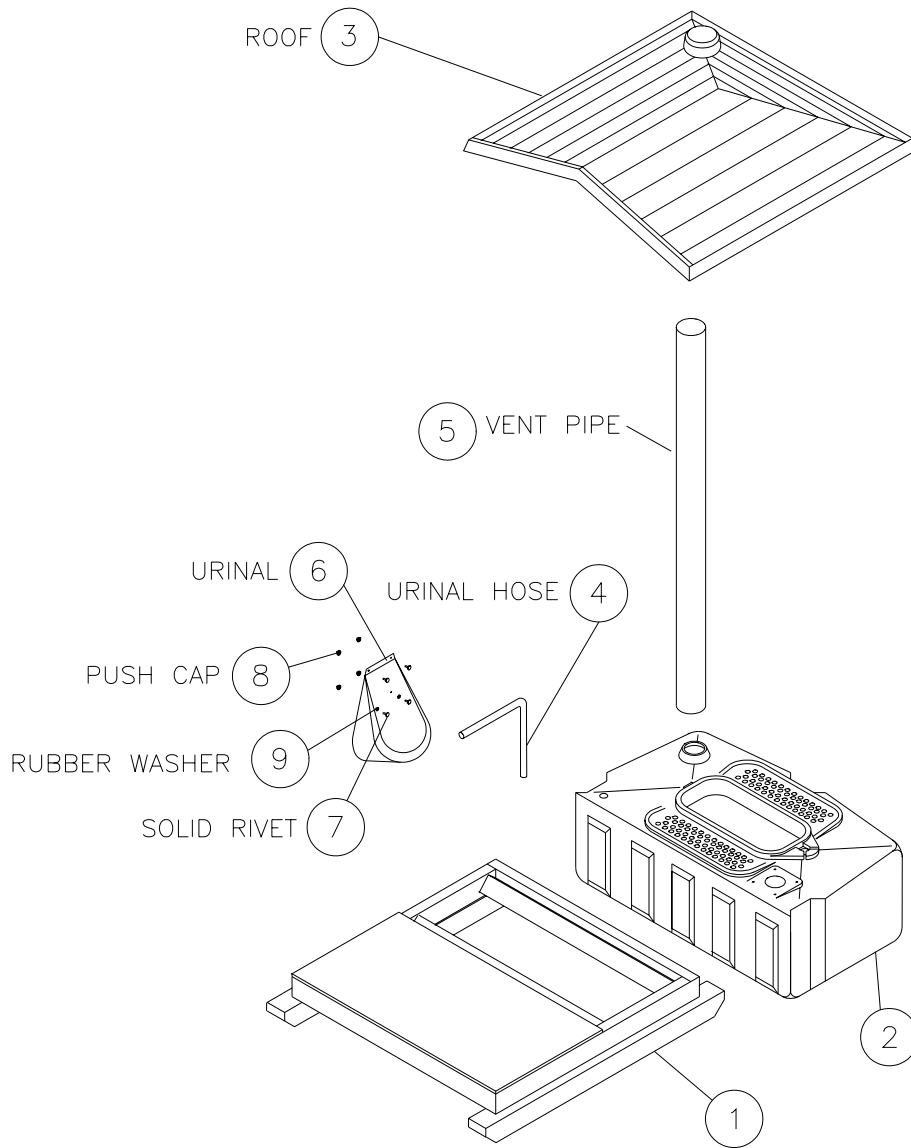

ITEM	P.N.	QTY	DESCRIPTION
1	17490	1	BASE, 4X4 RECYL PLST EASTERN
2	14565	1	TANK, EASTERN II
3	13298	1	ROOF, TUFWAY CORNER VENT NATURAL
4	13183	1	HOSE, URINAL ELBOW
5	11946	1	VENT PIPE, 4" X 68"
6	11999	1	URINAL, SPLASHGUARD
7	10801	4	RIVET, SOLID LONG
8	10047	4	PUSH CAP, 3/16"
9	10068	2	WASHER, 3/16" RUBBER

SPLASHGUARD URINAL OPTION

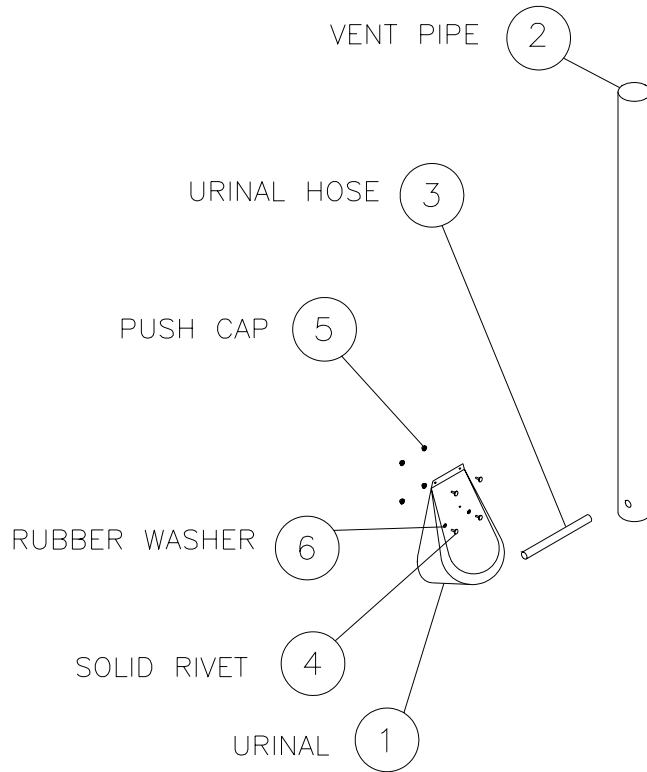

ITEM	P.N.	QTY	DESCRIPTION
1	11999	1	URINAL, SPLASHGUARD
2	12683	1	VENT PIPE, 4" X 68" W/1-3/16 HOLE
3	12707	1	HOSE, URINAL POLY PLUS
4	10801	4	RIVET, SOLID LONG
5	10047	4	PUSH CAP, 3/16" RUBBER
6	10068	2	WASHER, 3/16 RUBBER

INSTALLING THE SPLASHGUARD URINAL

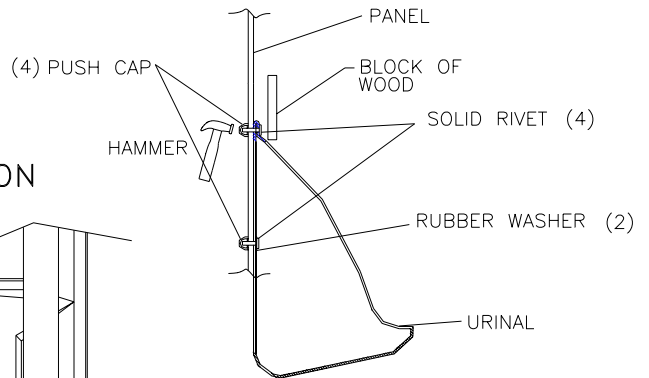
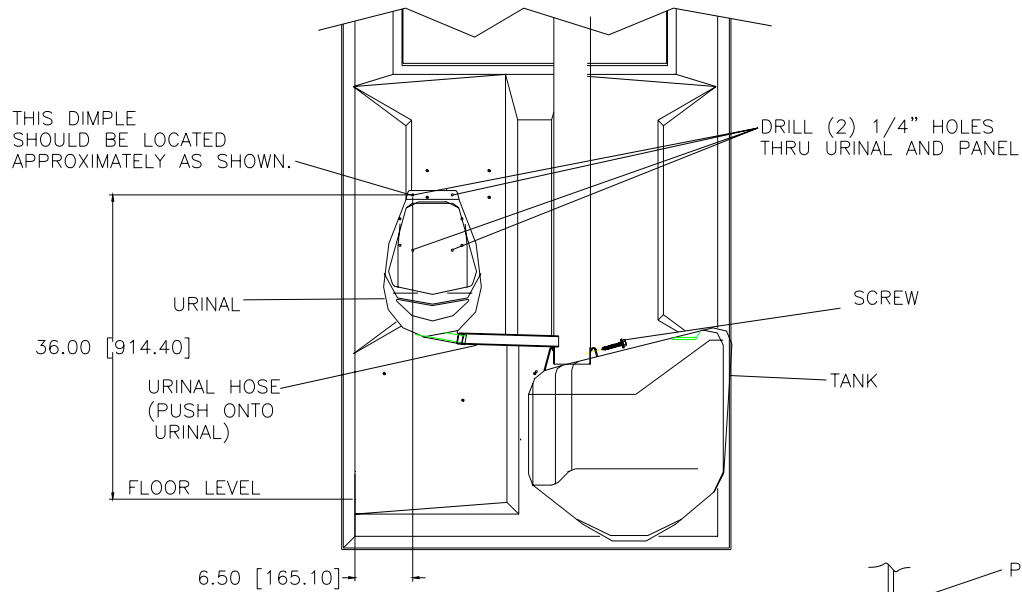

EASTERN OPTION

